

FLEX bench

A FLEXIBLE BOX BUILD WORKSTATION



BLISS

INDUSTRIES, INC.

408-945-8401

www.blissindustries.com

FLEXbench

A FLEXIBLE BOX BUILD WORKSTATION

FLEXBENCH STRUCTURE, 84"H SINGLE SIDED



P/N: 9810-001-11

- SINGLE OPERATOR USE FROM ONE SIDE
- 37" WIDE
- SUPPORTS A WIDE VARIETY OF ACCESSORIES
- TOTAL LOCK CASTERS STANDARD
- ESD SAFE

FLEXBENCH STRUCTURE, 84"H DOUBLE SIDED



P/N: 9810-050-11

- DUAL OPERATOR USE FROM EACH SIDE
- 37" WIDE
- SUPPORTS A WIDE VARIETY OF ACCESSORIES
- TOTAL LOCK CASTERS STANDARD
- ESD SAFE

MONITOR/KEYBOARD SWIVEL SHELF

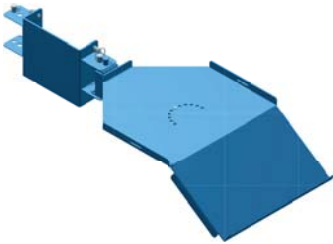

P/N: 9840-200-11

- SWING ARM AND PLATFORM
- OFFERS A SOLID BASE TO SUPPORT A COMPUTER MONITOR UP TO 17"
- SUPPORTS COMPUTER KEYBOARD WITH BUILT IN ANGLED SHELF.

COMPUTER TOWER SHELF



P/N: 9840-225-11

- ADJUSTABLE HEIGHT, HOLDS MOST POPULAR "TOWER" STYLE COMPUTERS BELOW WORK AREA.

SHELF, 12" DEEP

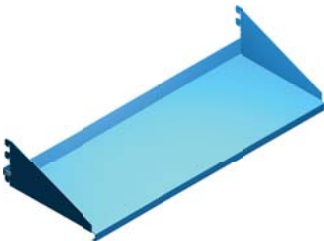

P/N: 9810-010-11

- IDEAL FOR SMALL TEST EQUIPMENT, DOCUMENT BINDERS
- WILL ACCOMMODATE STORAGE BINS UP TO 12" LENGTH.

SHELF, 18" DEEP

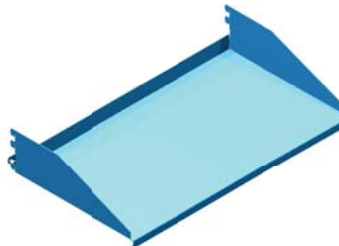

P/N: 9810-025-11

- IDEAL FOR SMALL TEST EQUIPMENT, DOCUMENT BINDERS
- WILL ACCOMMODATE STORAGE BINS UP TO 18" LENGTH.

OVERHEAD TROLLEY RAIL, W/I HANGER



P/N: 9840-375-11

- SMOOTH GLIDING MECHANISM ALLOWS HANGING ELECTRIC AND PNEUMATIC TOOLS TO BE EASILY POSITIONED.

ELECTRIC OUTLET STRIP, 36"



P/N: 9852-300-11

- OUTLET STRIP IS RATED AT 15 AMPS, INCLUDES SIX OUTLETS, AND 6' GROUNDED CORD.

BIN RAIL



P/N: 9840-100-01

- ACCOMMODATES MOST POPULAR BRANDS OF HANGING PLASTIC BINS.

A Step Towards Lean Manufacturing
Complete details and catalog online



BLISS
INDUSTRIES, INC.

386 Railroad Ct.
Milpitas, CA 95035

Phone: 408-945-8401 • Fax: 408-945-1914

sales@blissindustries.com • www.blissindustries.com